

S5076

11-19 CHEV/GMC 2500/3500 HD, 6.0L, CAT
BACK, 3.5" SINGLE SIDE

MBRP

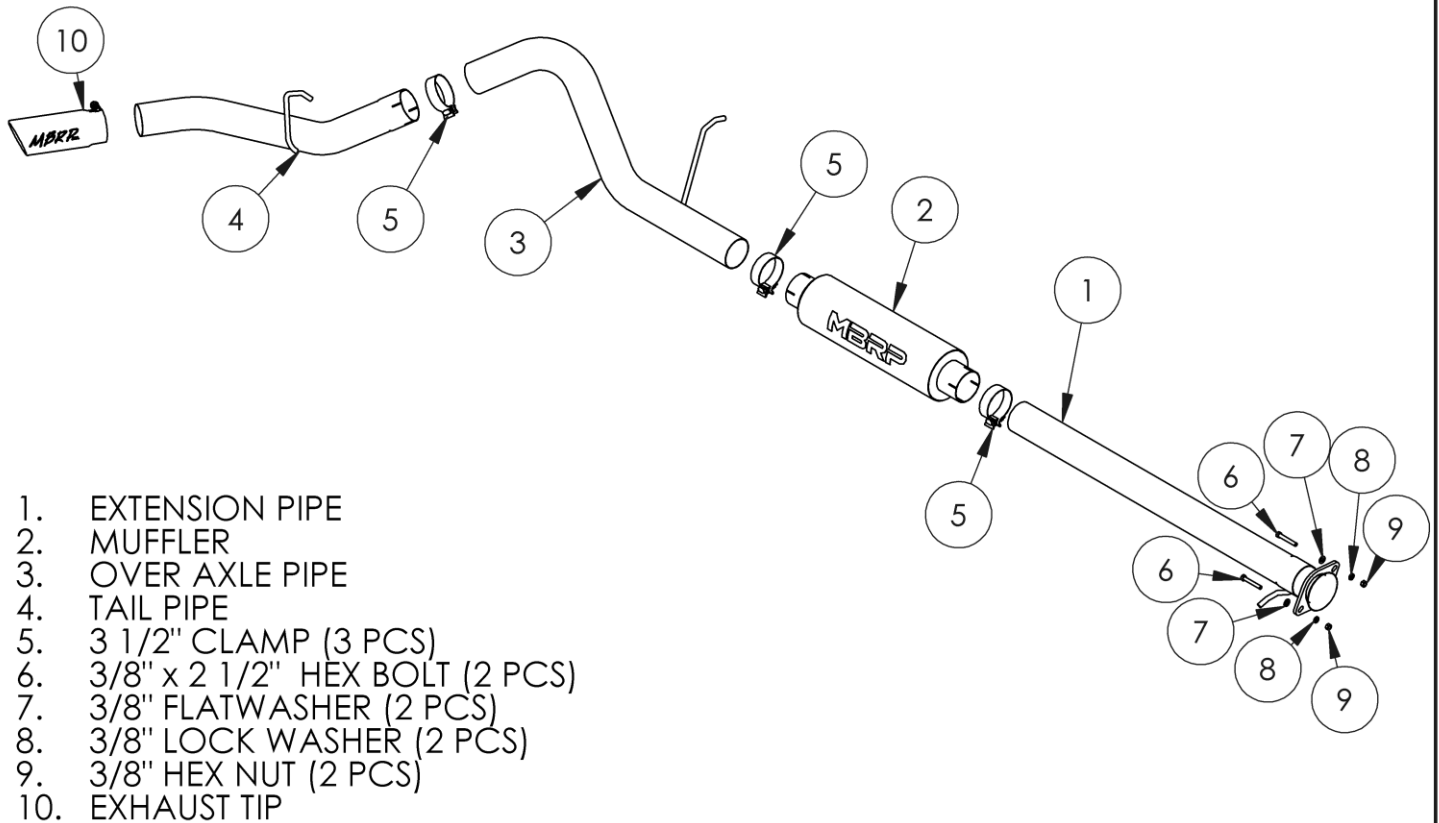

1. EXTENSION PIPE
2. MUFFLER
3. OVER AXLE PIPE
4. TAIL PIPE
5. 3 1/2" CLAMP (3 PCS)
6. 3/8" x 2 1/2" HEX BOLT (2 PCS)
7. 3/8" FLATWASHER (2 PCS)
8. 3/8" LOCK WASHER (2 PCS)
9. 3/8" HEX NUT (2 PCS)
10. EXHAUST TIP

NOTE: SADDLE CLAMPS ARE USED ON ALUMINIZED SYSTEMS

PLEASE READ BEFORE STARTING INSTALLATION

While MBRP has made every effort to ensure that all components of this system are of superior quality and properly packaged, it is the installer's responsibility to ensure the following before removal of the factory exhaust:

- that ALL components shown above are present.
- that ALL mating components fit together.
- that there are no damaged components.
- that the system you have purchased is appropriate for your vehicle year, model and configuration.
- that the system will not interfere with any modifications previously installed or planned.
- that you have read and understand these instructions.

If you have any questions or are uncertain about any aspect of the installation of this system to your vehicle please contact your dealer before commencing installation.

MBRP

Removal of Stock System



Figure 1



Figure 2



Figure 3

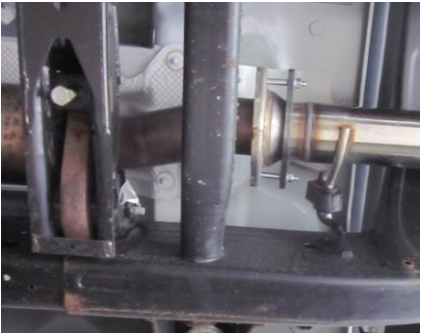

Figure 4

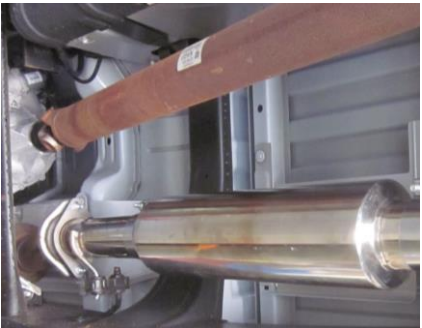
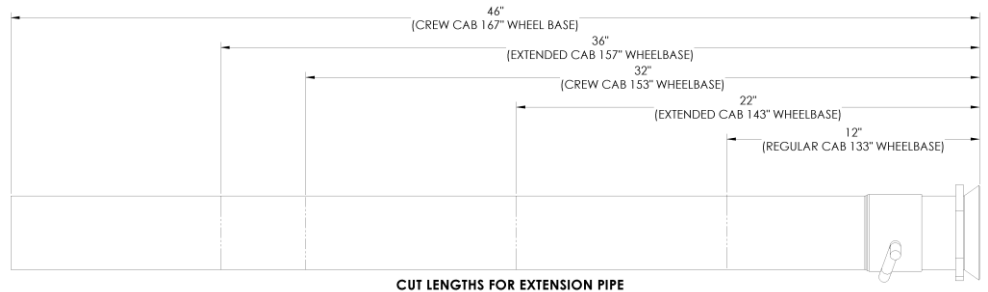

Figure 5

1. Apply a penetrating lubricant liberally to all exhaust fasteners, hangers and rubber insulators.
2. Remove the nuts from the studs holding the front flange together and disconnect the exhaust system. **Refer to Figures 1.**
3. Remove the hangers from the rubber insulators and remove the exhaust from the vehicle. **Refer to Figures 2 to 3.**

Installation of MBRP Performance Exhaust

1. Install the **Extension Pipe** to the existing flange. Attach the hanger to the rubber insulator located on the frame. Leave the hardware loose enough for some adjustment. **Refer to Figure 4.** Note the **Extension Pipe** is the correct length for the crew cab long bed (167" wheelbase). The **Extension Pipe** will require trimming for other models. **Refer to the diagram below.**



2. Slide a **3 1/2" Clamp** onto the rear of the **Extension Pipe**. Install the **Muffler** onto the **Extension Pipe**. **Refer to Figure 5.**

MBRP



Figure 6

3. Slide a **3 1/2" Clamp** onto the rear of the **Muffler**. Feed the **Over Axle Pipe** into the rear of the **Muffler**. Install the hanger on the **Over Axle Pipe** onto the existing rubber insulator. **Refer to Figure 6.**



Figure 7

4. Install the **Tail Pipe** hanger into the factory rubber insulator located directly above the hanger and attach to the **Over Axle Pipe** using a **3" Clamp**. **Refer to Figure 7.**



Figure 8

5. Install and adjust the **Exhaust Tip** to suit. Tighten the bolt located on the **Exhaust Tip**. **Refer to Figure 8.**

6. Tighten all hardware and clamps, starting at the front and working rearward to secure the system. Check along the full length of the exhaust system to ensure there is adequate clearance for fuel lines, vent lines, brake lines, frame, bodywork, suspension and any wiring, etc. If there is any interference detected, relocate or adjust to provide adequate clearance. Ensure all clamp connections are secure and components are unable to rotate or slide. Band clamps require approximately 45 lb-ft (60 N-m) of torque. Verify clearances, system security and band clamp torque after 30-60 miles (50-100 km) of driving.

Congratulations! You are ready to begin experiencing the improved power, sound and driving excitement of your **MBRP** performance exhaust system. We know you will enjoy your purchase.